

1 TYPICAL RAILING SECTION (@ Ramp + Stain Areas All Horizontal Elements Slope)  
Scale: 1" = 1'-0"

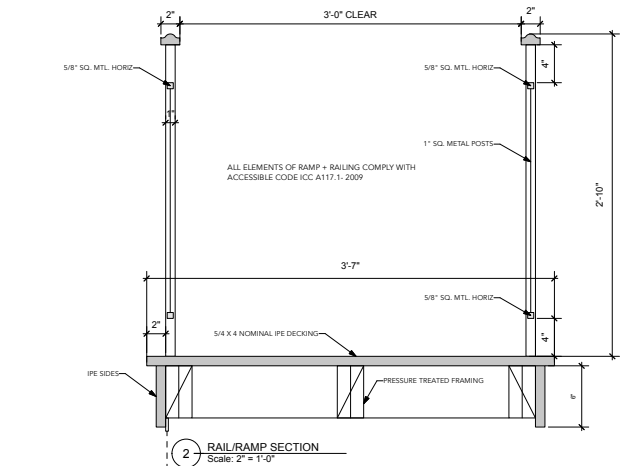

2 RAIL/RAMP SECTION  
Scale: 2" = 1'-0"

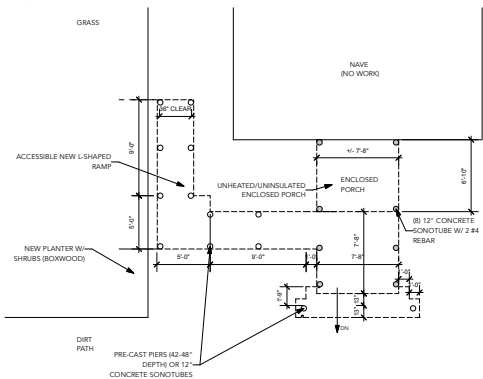

3 FOUNDATION PLAN  
Scale: 3/16" = 1'-0"

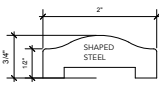

4 RAILING CAP  
Scale: Actual Size



5 PHOTO SHOWING CHURCH AND PORCH  
Scale: NTS

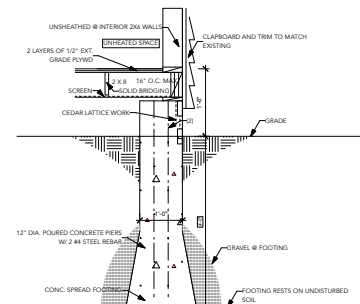

6 CONCRETE PIER DETAIL  
Scale: 3/4" = 1'-0"

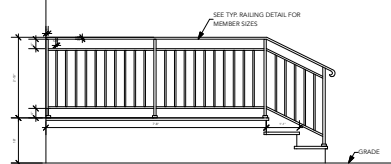

7 SIDE PORCH ELEVATION  
Scale: 1/2" = 1'-0"



8 FRONT PORCH + RAMP ELEVATION  
Scale: 1/2" = 1'-0"

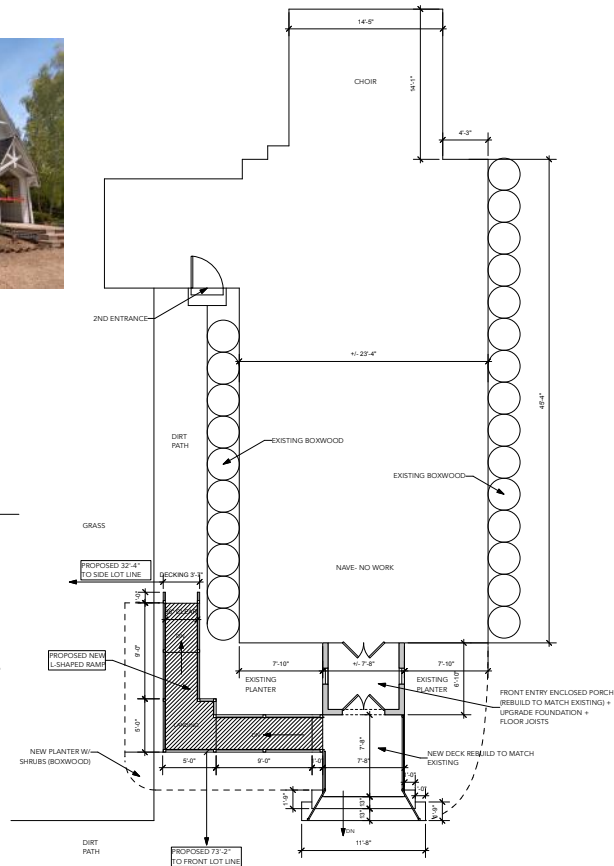

9 PLAN  
Scale: 3/16" = 1'-0"

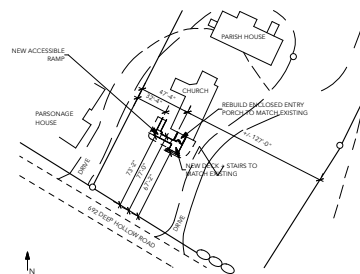

10 SITE PLAN  
Scale: NTS

# TURINO KALBERER ARCHITECTS

79 MADISON AVENUE, 8TH FLOOR  
NEW YORK, NY 10016  
(212) 219-3007  
julie@tkanyc.com

SCOPE OF WORK:  
1) FRONT ENTRY PORCH  
DISASSEMBLE EXISTING W/ INTENT ON RE-USING  
AS MUCH HISTORICAL MATERIAL AS POSSIBLE  
SUCH AS POSTS, SPECIAL CROSS-BRACING +  
OTHER WOOD MAJOR ELEMENTS, ENTRY DOORS +  
STAINED GLASS WINDOWS.  
UPGRADE FOUNDATION + FLOOR JOISTS AS  
SHOWN  
NEW BAFTERS + ASPHALT SHINGLES  
7) DECK AREA W/ STAIRS  
REBUILD TO MATCH EXISTING WITH UPGRADED  
FOUNDATION PIERS AND ALL NEW ELEMENTS  
7) NEW ACCESSIBLE RAMP

This is previous  
drawing from  
August ZBA  
approval. Provided  
here for reference  
only.

ZONING BOARD OF APPEALS  
APPLICATION NOTES:  
1) RR-10 ZONING  
2) APPLICATION FOR NEW PROPOSED  
RAMP ONLY  
3) REQ'D SIDE YARD= 100'  
REQUESTED SIDE YARD= 32'-4"  
4) REQ'D FRONT YARD= 100'  
REQUESTED FRONT YARD= 73'-2"  
5) NO VARIANCE REQUESTED FOR 2ND  
LOT LINE SETBACK (+/- 127'), OR REAR  
REQUIRED SETBACK (+/- 556')

DATE:  
PROJECT:  
ST PETER'S CHURCH  
692 Deep Hollow Rd.  
Millbrook, NY 12545

DRAWING TITLE:  
REBUILDING OF FRONT ENTRY  
PORCHES AND NEW  
ACCESSIBLE RAMP

SEAL & SIGNATURE: DATE: 07/07/21  
SCALE: AS NOTED  
DRAWN:  
DRAWING No:  
A1

ST PETER'S CHURCH